



WELL STREET, LONDON, E9

£1,950 PCM

* VIRTUAL TOUR AVAILABLE * Goldman Greg are delighted to offer this one bedroom first floor apartment located in a modern building on Well Street, London, E9.

The apartment benefits from being finished to a high specification throughout offering a modern kitchen with integrated appliances as well as being open plan with a good size living space, built in storage and double glazed.

Well Street is located within close proximity to London Fields Station and walking distance to good local amenities on Mare Street.

Available from the 12th December 2025, early viewings are highly recommended of this property to avoid disappointment.



Goldman Greg

Well Street, E9 7PX

Approx. Gross Internal Area = 42.8 sq m / 460 sq ft

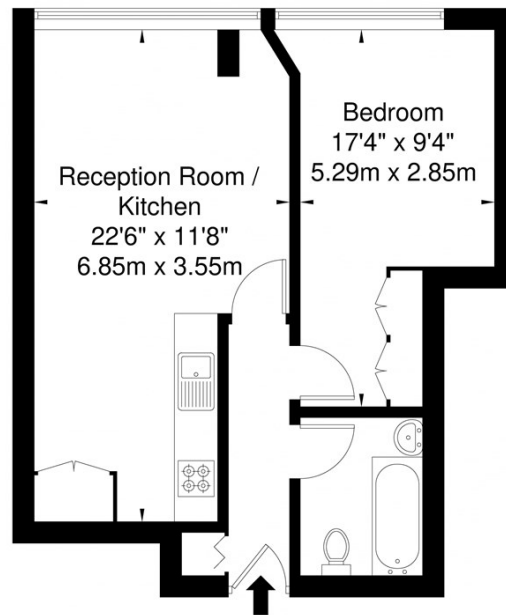

First Floor

Ref

Copyright
**BLEU
PLAN**

The Floor plan is not to scale and measurements and areas shown are approximate and therefore should be used for illustrative purposes only. The plan has been prepared in accordance with the RICS code of Measuring Practice and whilst we have confidence in the information produced it must not be relied on. If there is any aspect of particular importance, you should carry out or commission your own inspection of the property.
Copyright © BLEUPLAN

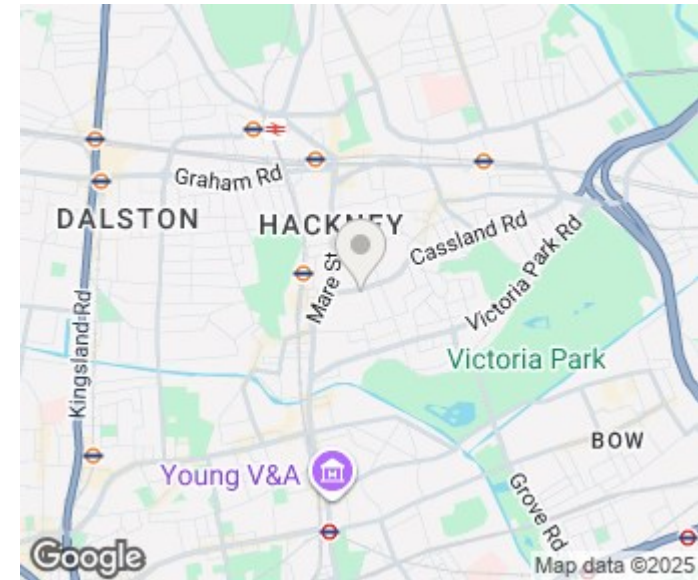

Energy Efficiency Rating		
	Current	Potential
Very energy efficient - lower running costs		
(92 plus) A		
(81-91) B		
(69-80) C		
(55-68) D		
(39-54) E		
(21-38) F		
(1-20) G		
Not energy efficient - higher running costs		
England & Wales	EU Directive 2002/91/EC	

Agents Note: Whilst every care has been taken to prepare these particulars, they are for guidance purposes only. All measurements are approximate and are for general guidance purposes only and whilst every care has been taken to ensure their accuracy, they should not be relied upon and potential buyers/tenants are advised to recheck the measurements

Goldman Greg
143 Leman Street
London
E1 8EY

02079770018
leads@goldmangreg.co.uk
www.goldmangreg.co.uk

